



KC104D PANEL MOUNT

A durable dry type utility gauge designed to look good from the front or back of the panel. These gauges are suitable for air, water, oil, gas or any other media not corrosive to brass. Other connection locations, mounting styles and accessories are also available. Ready for immediate shipment upon request.

SPECIFICATIONS:

- AVAILABLE DIAL SIZES:** 1 1/2", 2", 2 1/2", 3 1/2"
- AVAILABLE CONNECTION SIZES:**
 - 1/8"NPT on 1 1/2" and 2"Dial Sizes
 - 1/4"NPT on 2" Thru 3 1/2"Dial Sizes
- Chrome Plated Steel Case, Chrome Bezel**
- Phosphour Bronze Bourdon Tube**
- Brass Socket**
- Polycarbonate Lens**
- 3-2-3 % Accuracy**
- Dry Non-Fillable**
- Ambient Temperature: -50 to 160°F**
- Dual scale: PSI & Bar (x100=kpa)** *standard available*
- Single scale: PSI only** *available*
- Other:** *by special request*



RANGE	CODE	Major Inc.	Minor Inc.
30/0"VAC	A	5" hg	.5" hg
30/0/15	CB	10"hg / 5 psi	1"hg / .5 psi
30/0/30	CC	10"hg / 10 psi	1"hg / 1 psi
30/0/60	CD	10"hg / 10 psi	2"hg / 1 psi
30/0/100	CE	30"hg / 20 psi	5"hg / 2 psi
30/0/150	CF	30"hg / 20 psi	5"hg / 2 psi
30/0/300	CH	30"hg / 50 psi	10"hg / 5 psi
0/15	B	2 PSI	.2 PSI
0/30	C	5 PSI	.5 PSI
0/60	D	10 PSI	1 PSI
0/100	E	20 PSI	2 PSI
0/160	F	20 PSI	2 PSI
0/200	G	40 PSI	5 PSI
0/300	H	50 PSI	5 PSI
0/400	I	50 PSI	5 PSI
0/600	K	100 PSI	10 PSI
0/1000	M	200 PSI	20 PSI
0/1500	N	200 PSI	20 PSI
0/2000	O	400 PSI	50 PSI
0/3000	P	500 PSI	50 PSI
0/5000	R	1000 PSI	100 PSI
0/6000	S	1000 PSI	100 PSI
0/10,000	U	2000 PSI	200 PSI

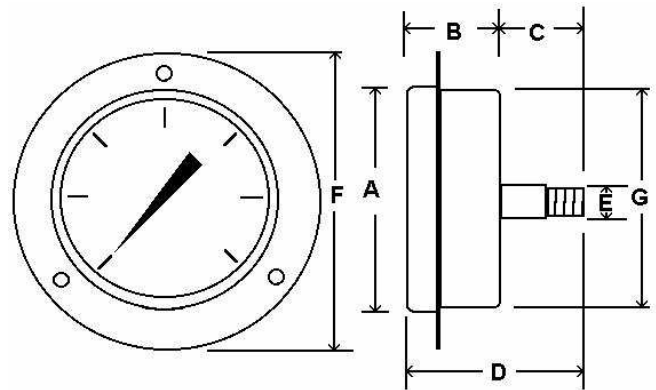

		A	B	C	D	F	G	E
1 1/2" Dial	In.	1.82"	1.03"	.61"	.64"	2.47"	1.61"	1/8" MNPT
	MM	46	26	15	42	63	41	
2" Dial	In.	2.31"	1.17"	.73"	.90"	2.81"	2.02"	1/8 or 1/4 MNPT
	MM	59	30	18.5	48.5	71	51	
2 1/2" Dial	In.	2.68"	1.19"	.76"	.95"	3.44"	2.46"	1/4 MNPT
	MM	68	30	19	50	87	63	
3 1/2" Dial	In.	3.97"	1.19"	.83"	2.02"	4.30"	3.59"	1/4 MNPT
	MM	101	30.2	21	51	109	91	